

赤ちゃん医学から生まれた

Aprica

cookie

使用説明書／保證書

謝謝您購買本公司產品。此產品適用於出生後6個月起到36個月，體重在15kg以內的嬰幼兒一人使用的嬰幼兒手推車。



使用前請仔細閱讀本說明書並正確使用。請妥善保管本說明書。未安裝好的零件請仔細閱讀本說明書並正確安裝。本書使用後必須妥善保管。

アップリカ・チルドレンズプロダクツ株式会社

Aprica Children's Products Inc.

研究本部 — 〒632-0231 奈良県奈良市都祁吐山町3529

本社/大阪店 — 〒542-0082 大阪市中央区島之内1-13-13 TEL(06)6245-2571

東京銀座店 — 〒104-0061 東京都中央区銀座2-6-12 TEL(03)3535-6767

台灣愛普力卡股份有限公司 銷售

台灣新竹縣303湖口鄉新竹工業區光復南路50號

維修課專線：03-5986384 傳真：03-5982742

網址：http://www.aprica.com.tw

467-8T01-TIW

目次



使用前	1
關於本書的標示	1
使用上請注意	1
警告	1
注意	3
禁止	3
產品取出時	4
各部位名稱	4
產品的特徵	4
嬰幼兒乘坐前	5
開啟嬰幼兒手推車方法	5
前輪固定器的使用方法	6
後輪固定器的使用方法	6
嬰幼兒乘坐時	7
腰帶・肩帶的拆卸方法	7
肩帶的高度調節方法	7
嬰幼兒乘坐時肩帶固定方式	7
股帶的調節方法	8
腰帶的調節方法	9
肩帶的調節方法	10
關於操作方法	10
遮陽罩的使用方法	10
置物籃的使用方法	10
揹帶的使用方法	11
收折嬰幼兒手推車的方法	11
縫製品的保養方法	13
遮陽罩的拆卸方法	13
〈安裝時〉	13
置物籃的拆卸方法	13
〈安裝時〉	13
股帶保護套的拆卸方法	14
清涼緩衝座墊的拆卸方法	14
縫製品清潔時	15
日常簡易保養	15
關於檢查與售後服務	16
保管方法	16

使用前

適用範圍	本產品用於嬰幼兒外出、購物等一人乘坐的嬰幼兒手推車。
使用期間	從出生後6個月起到36個月為止。
體重限制	15kg以下
希望連續使用時間	坐姿1小時以內

關於本書的標示

※「警告」、「注意」、「禁止」等符號標示臆測您在未遵守注意事項的情況下依據危害、損害危險程度或是嚴重性來區分內容非常重要，請您務必遵守。

表示	表示內容
 警告	使用方式錯誤時，可能會造成使用者死亡或重傷等情形。
 注意	使用方式錯誤時，可能會造成使用者受傷或物品損壞的情形。
 禁止	本說明書上所禁止的行為是絕對不可以進行的。

使用上請注意

避免意外事故的發生，使用前請務必詳閱說明書並依說明書上指示，正確使用嬰幼兒手推車。

 警告 使用方式錯誤時，可能會造成使用者死亡或重傷等情形。

· 因恐寶寶不慎掉落而有受傷之虞。

· 因恐嬰幼兒手推車傾倒，導致寶寶掉落而有受傷之虞。



· 請勿將安全腰帶及安全股帶拆下。



· 請勿讓兩名嬰幼兒同時乘坐或搭乘於座墊以外的地方。



· 腰部安全帶鬆弛時，也有可能在站起時跌倒、掉下。請依寶寶成長狀態調節腰部安全帶。



· 上下樓梯、電動手扶梯或是在有段差的地方，請勿使用。

 警告 使用方式錯誤時，可能會造成使用者死亡或重傷等情形。

· 因恐寶寶不慎掉落而有受傷之虞。

· 因恐嬰幼兒手推車傾倒，導致寶寶掉落而有受傷之虞。



· 請勿讓寶寶站立於嬰幼兒手推車之上。



· 當寶寶乘坐於嬰幼兒手推車時，除置物籃外請勿將其他物品懸掛於把手或是懸掛過重物品。

· 因恐在斜坡之處嬰幼兒手推車任意滑動傾倒而造成孩童受傷之虞。

· 因恐造成嬰幼兒不慎摔傷或嬰幼兒手推車折疊方式不當而將嬰兒夾住。



· 當寶寶坐上或是置放物品時請勿過度相信後輪固定器（構造上和汽車用安全煞車系統不同）。



· 當寶寶乘坐時，請勿直接將嬰幼兒手推車提起懸空。



· 當寶寶乘坐時或是下車時請務必將後輪固定器鎖上並確認嬰兒車不會移動。



· 嬰幼兒手推車使用前時，請確認左右開關鎖是否完全扣住。



· 當寶寶乘坐嬰幼兒手推車時請勿離開。



· 夏天白天使用時，由於路面的影響使得嬰幼兒手推車的溫度會變得很高，所以避免長時間使用。



注意

使用方式錯誤時，可能會造成人員的受傷、物體的故障、異常等原因發生，請務必遵守。

- 操作各部位時，請特別注意各項細節。
- 請特別注意各個可動關節部位在收車或打開車體時避免夾傷寶寶或使用者，並注意避免過大的動作導致車體撞及寶寶或使用者本人。

錯誤或粗心的使用將造成遺憾的事故發生或人身受傷，請特別注意。



- 當您操作折疊收納嬰幼兒推車時，請注意勿讓寶寶或幼童靠近。



- 當您推動嬰幼兒推車時，請避免過度的施力以避免夾傷手指或導致車體撞及自己的身體。

- 使用時請注意螺絲、螺帽等是否鬆動。
- 請勿將前輪呈高舉狀態行走(此動作易導致後部框架彎曲變形或斷裂)。
- 請勿讓幼童操作嬰幼兒手推車。
- 當您操作折疊收納嬰幼兒推車時，請盡量迴避，勿讓寶寶或幼童靠近。
- 當寶寶乘坐嬰幼兒手推車行進時，為了寶寶的安全，請以普通步行速度(時速約4公里左右)行進。
- 體重15kg以上的幼童請勿乘坐。
- 即使是空車，也請勿將嬰幼兒手推車放置於斜坡上或是靠近車道的人行道等危險場所。
- 絕對禁止將安全帶纏繞於安全護桿上使用(此動作會導致安全帶破裂)。
- 請勿將嬰幼兒手推車推至沙地或是泥濘處(關節轉折處易因沙粒進入造成開關收納困難)。
- 請勿放置靠近火源處或炎夏高溫車內(容易造成樹脂變形而無法維持其原有功能之可能性)。
- 框架處沾染沙粒或泥土時請勿置之不理(關節滑動處易因沙粒進入造成開關收納困難)。
- 請勿將兩輛嬰兒車連在一起使用。
- 即使繫著安全帶寶寶也有可能站起，請多加注意。
- 依路面的狀態、構造、機能及耐久性等方面的不同，不能太相信煞車。在構造上嬰兒車的煞車結構不同於停車煞車那樣的安全。
- 經過平交道時，要十分小心，不要讓車輪卡在軌道上。
- 不要進行有可能造成嬰幼兒手推車故障的操作。



禁止

嬰幼兒手推車是專為嬰幼兒所設計、請特別注意絕對禁止以下的使用。

- 本公司維修人員以外的分解安裝、改造。
- 在螺絲、螺帽鬆動狀態下使用。
- 禁止保護人坐在側扶手、前扶手上。
- 使用於貨物的搬運。
- 懸掛物品於安全扶手或安全護桿搬運使用。
- 施以猛力撞擊或掉落後使用。
- 當成兒童玩具來使用。
- 禁止將本車用於孩子乘坐之外的任何目的使用。

產品取出時

- 產品取出後，請確認附件是否齊全，有無破損。
- 如有產品不齊全或破損時，請與購買店或本公司聯繫。

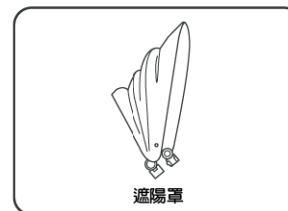
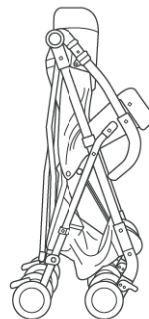

遮陽罩

- 嬰幼兒手推車打開時請參照P5。
- 打開遮陽罩時請參照P13。



<附屬品>

使用說明書

各部位名稱

- 製品特徵
- 車身使用輕量型鋁管。
- 車把背面側固定。
- 前輪為轉向輪。
- 車體折疊後為自立狀態。
- 前後左右折疊方式。

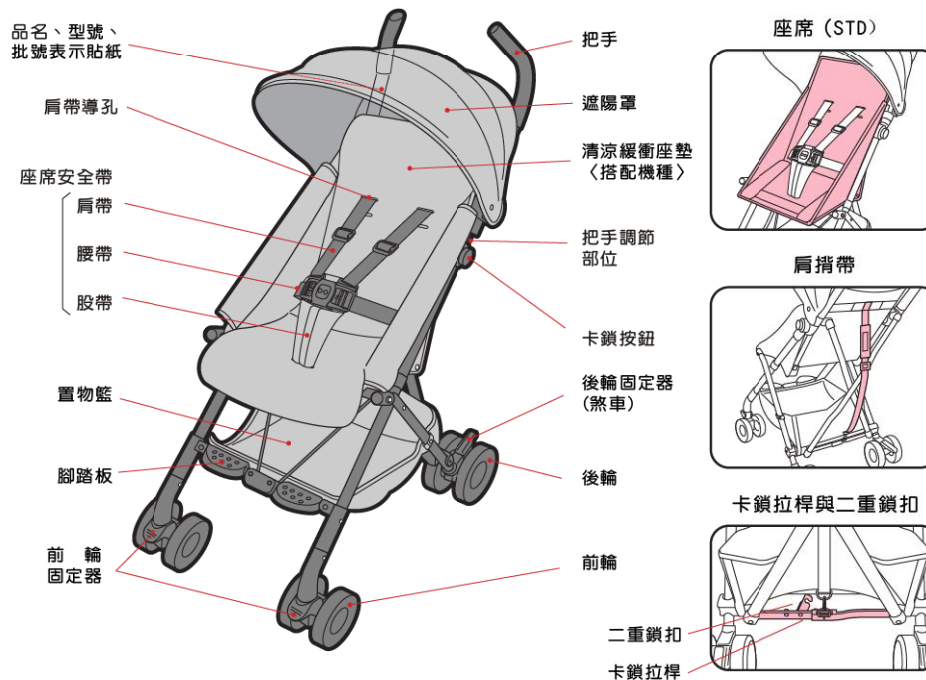

嬰幼兒乘坐前

開啟嬰幼兒手推車方法



- 注意**
- 使用時請注意，不要讓可動關節部位夾到使用者的手或手指。
 - 使用方法錯誤時，可能造成使用者發生意外事故或重傷等情形。
 - 操作時確認嬰幼兒是否在周邊。



① 用雙手按住左右的卡鎖按鈕。



② 按住卡鎖按鈕，向下按住把手調節部位。
③ 用雙手握住把手。



- 注意**
- 必須按住按鈕的狀態下打開(請注意不要夾到手與手指)，再用雙手握住把手打開。



④ 打開

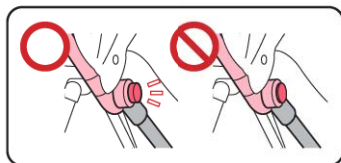

④ 打開把手。

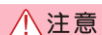

- 注意**
- 如果卡鎖沒有完全鎖住時，請再一次打開把手，確認是否鎖住。

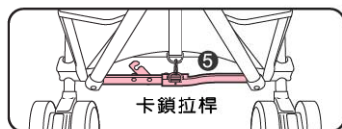

⑤ 按住卡鎖拉桿使之伸展開。



- 注意**
- 請確認卡鎖拉桿是否確實伸展開。

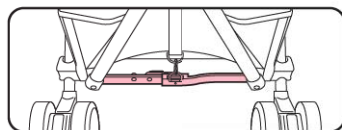

⑥ 扣上二重鎖扣。

前輪固定器的使用方法



- 注意**
- 行走於凹凸路面、坡道或是傾斜處時，請將左右兩側的前輪固定器固定住，並且請勿將行進方向的車輪位置固定住，一旦嬰幼兒手推車傾倒時嬰兒恐有受傷之可能。

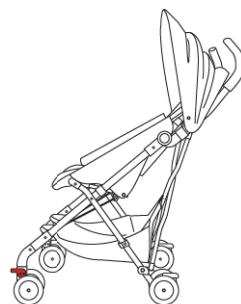

〈解除時〉

- 在平坦的道路上行走時。

〈鎖定時〉

- 在凹凸不平、坡道傾斜等路面行走時。
- 折疊起來時。

後輪固定器的使用方法



- 注意**
- 讓寶寶乘坐時，請不要太相信煞車。在構造上嬰兒車的煞車結構不同於停車煞車那樣的安全。

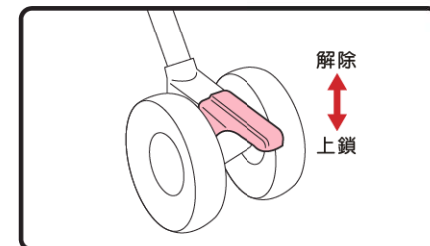
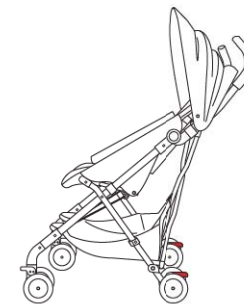

- 寶寶未乘坐時，離開嬰幼兒手推車時要鎖上後輪的左右煞車。

- 有寶寶乘坐時請不要離開嬰幼兒手推車。

- 輕輕地前後移動嬰幼兒手推車確認煞車是否確實固定住。

嬰幼兒乘坐時

- ⚠ 注意**
- 使用時請注意，不要讓可動關節部位夾到使用者的手或手指。
 - 使用方法錯誤時，可能造成使用者發生意外事故或重傷等情形。
 - 確認嬰幼兒乘坐前，左右兩側的煞車是否固定住。

1. 腰帶・肩帶的拆卸方法

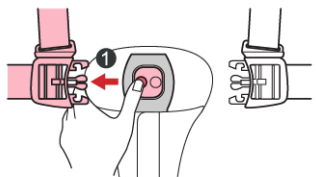

- ① 按下股帶左右的鎖扣，取下腰帶。

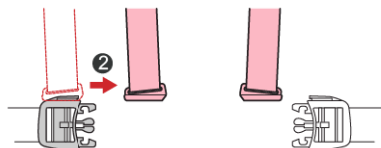

- ② 從腰帶鎖扣處取下肩帶。

2. 肩帶的高度調節方法

- 肩帶的位置可分2段調節。

⚠ 注意

- 根據寶寶的成長來調節肩帶的高度。

月齡(體格)為基準	肩帶導孔的位置
6個月~30個月	下段
24個月~36個月	上段

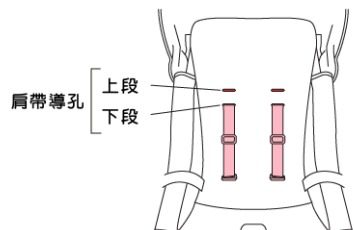

〈調節方法〉

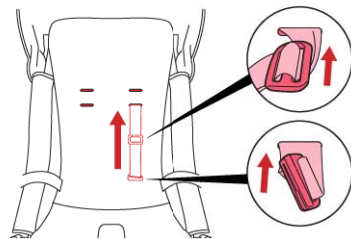

- ① 把肩帶從靠背的背面拔出來。

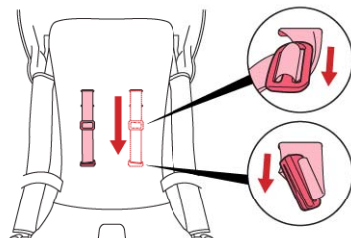

- ② 符合孩子的身體，從肩帶導孔處把肩帶穿過來。

3. 嬰幼兒乘坐時，肩帶固定方法

⚠ 注意

- 肩帶不能隨意的安裝，肩帶必須安裝在腰帶上才可以使用。肩帶有可能纏在孩子的脖子上會發生危險。

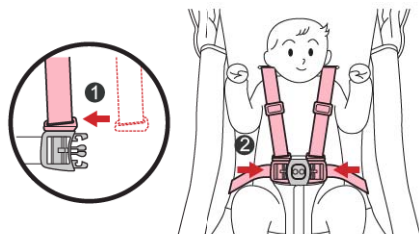

- ① 把肩帶插到腰帶上。
② 把腰帶插到股帶上。

4. 股帶的調節方法

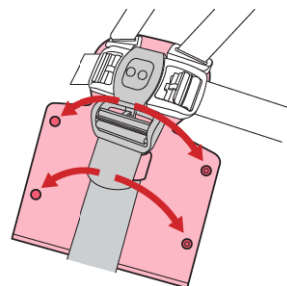

- 打開股帶保護套的扣子，取下股帶保護套。

〈縮短時〉

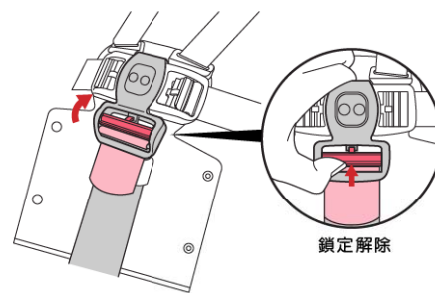

- ① 解除鎖定。

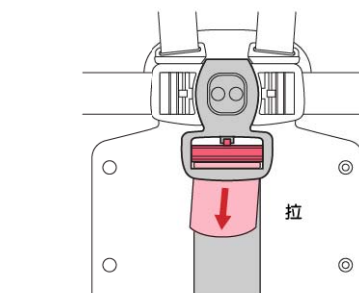

- ② 拉股帶。

〈伸長時〉

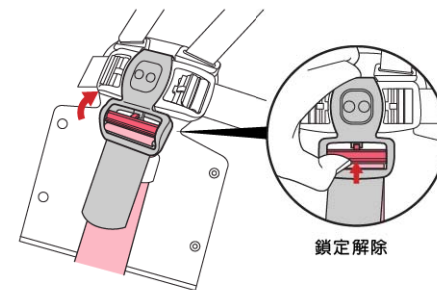

- ① 解除鎖定。

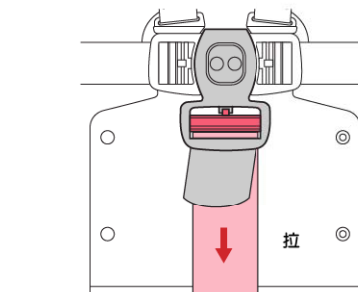

- ② 解除鎖定的狀態下將股帶往下拉。

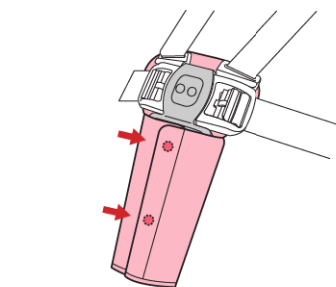

- 將股帶保護套的扣子扣上。

警告 · 腰部安全帶鬆弛時，也有可能在站起時跌倒、掉下。請依寶寶成長狀態調節腰部安全帶。

5.腰帶的調節方法

<縮短時>

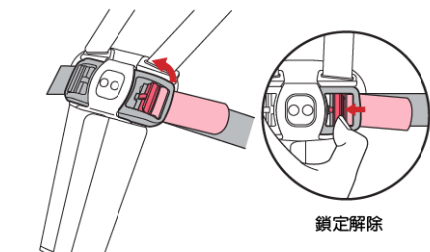

① 解除鎖定。

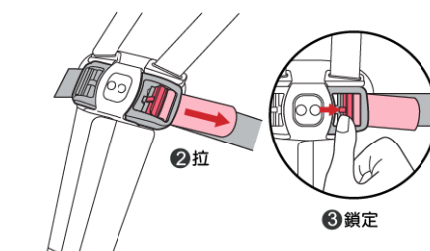

② 拉腰帶。
③ 鎖定。

<伸長時>

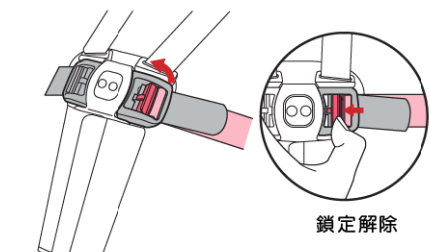

① 解除鎖定。

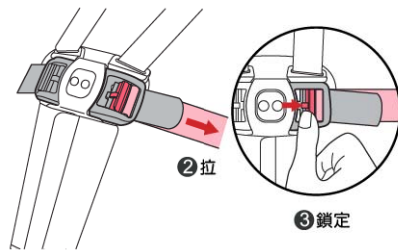

② 拉腰帶。
③ 鎖定。

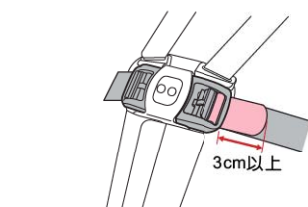

注意

· 腰部安全帶末端的保留部分(箭頭部分)一定要在3cm以上。

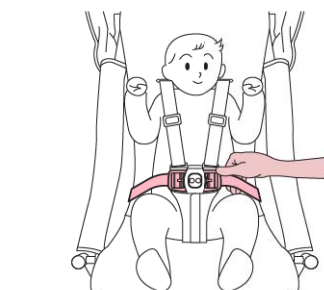

● 調節腰帶的長度。(腰帶的長度根據腰帶與寶寶間能插入大人4隻手指為宜)

6.肩帶的調節方法

<縮短時>

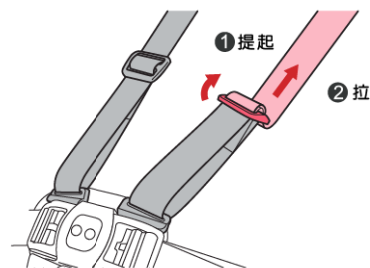

<伸長時>

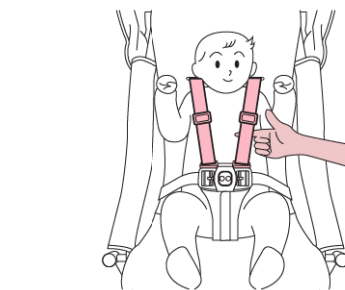
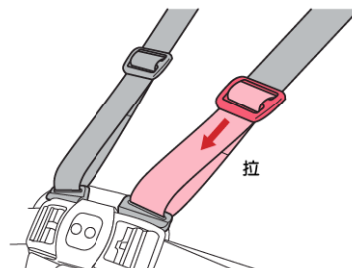

● 調節肩帶的長度。(肩帶的長度根據腰帶與寶寶間能插入大人1隻手指為宜)

關於操作方法

遮陽罩的使用方法

<遮陽罩打開時>

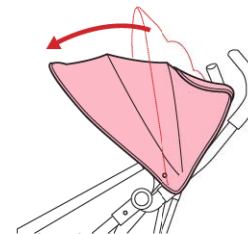

<打開天窗時> <限定機種>

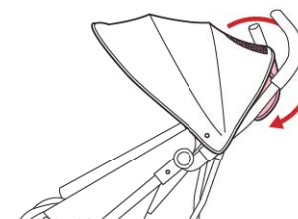

置物籃的使用方法

注意

- 請勿放入尖銳物品，恐有尖銳物品穿過縫隙而造成受傷之虞。
- 可負載物品重量請勿超過2.5公斤。



揹帶的使用方法

- 車體折疊時後，可利用肩揹帶提起車體揹於肩上行走。
- 請配合使用者的需求適度調整肩揹帶長度。

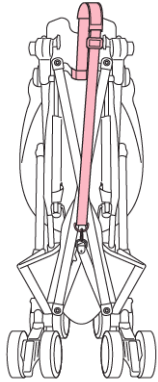

⚠ 注意

- 請先將車體上粘著的油、泥土、砂子等擦乾淨後使用。避免粘到衣服上。



- 打開的狀態下請調節適當的肩揹帶長度。

收折嬰幼兒手推車的方法

⚠ 注意

- 使用時請注意，不要讓可動關節部位夾到使用者的手或手指。
- 使用方法錯誤時，可能造成使用者發生意外事故或重傷等情形。
- 操作時確認寶寶是否在周邊。

<收折前>

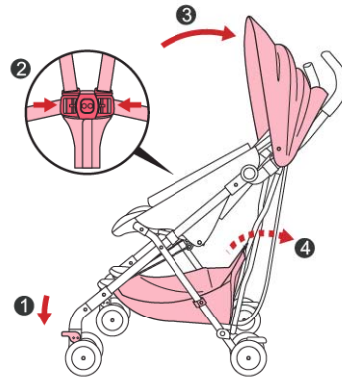

- ① 將左右前輪固定住。
- ② 把肩帶、腰帶固定在股帶上。
- ③ 關閉遮陽罩。
- ④ 從置物籃內把物品取出來。

⚠ 注意

- 使用時請注意，不要讓可動關節部位夾到使用者的手或手指。
- 使用方法錯誤時，可能造成使用者發生意外事故或重傷等情形。
- 操作時確認寶寶是否在周邊。

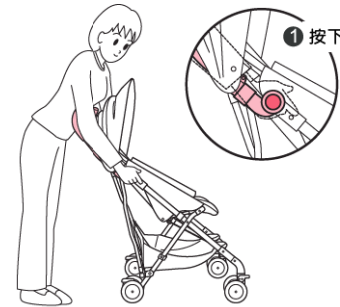

- ① 用雙手按左右的卡鎖按鈕。

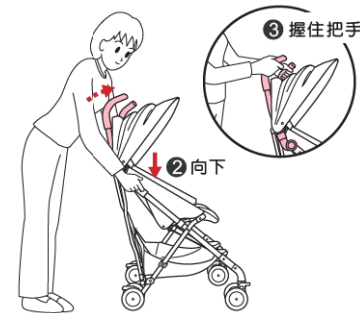

- ② 按住卡鎖按鈕，向下按住把手調節部位。
- ③ 用雙手握住把手。

⚠ 注意

- 按住按鈕的狀態下收折請注意不要夾到手與手指，再用雙手握住把手收折。

收折嬰幼兒手推車的方法

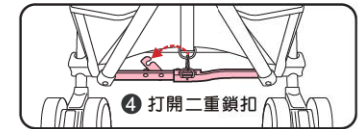

- ④ 打開二重鎖扣。

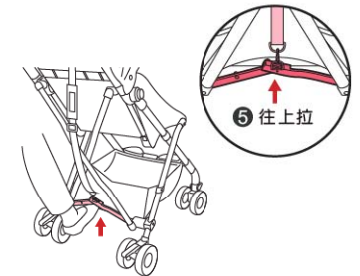

- ⑤ 向上拉鎖定連接桿的中央部位。拉住肩揹帶，鎖定連接桿即可拉起來。

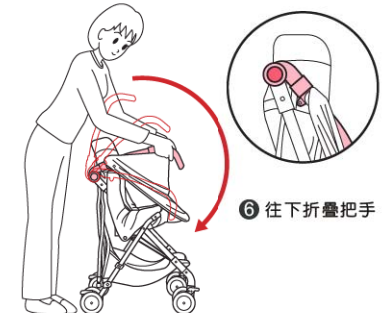

- ⑥ 關閉把手。

⚠ 注意

- 如果卡鎖沒有完全鎖住時，請再一次折疊把手，確認是否鎖住。

縫製品的保養方法

遮陽罩的拆卸方法

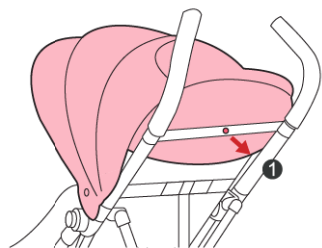

① 卸下背面的扣子。

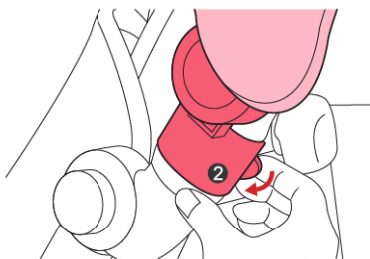

② 拉遮陽罩托座，並取下。

<安裝時>

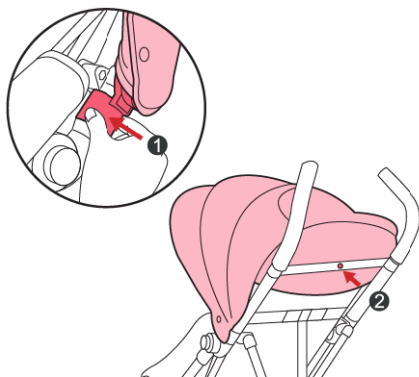

① 將遮陽罩壓在最裡面。
② 固定背面的扣子。

置物籃的拆卸方法

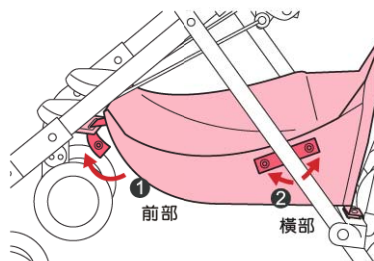

卸下 ① 前部、② 橫部(左右)的扣子。

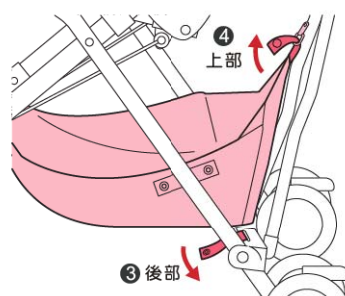

卸下 ③ 後部(左右)、④ 上部的扣子。

<安裝時>

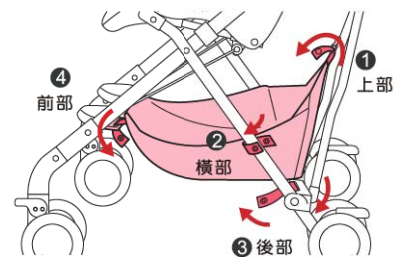

① 把上部的帶子從掛勾處穿過，並把扣子扣上。
② 把橫部的帶子捲在管子上，並把扣子扣上。(左右兩側)
③ 後部、④ 前部的帶子從通孔處穿過，用扣子扣上。(左右兩側)

股帶保護套的拆卸方法

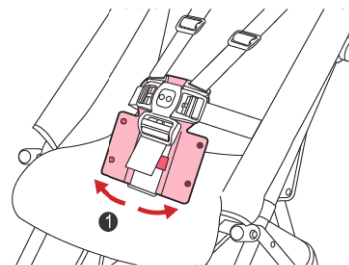

① 卸下扣子。

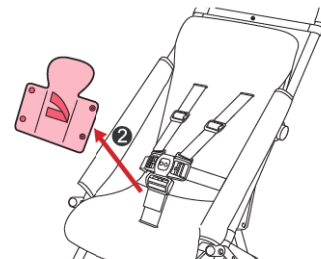

② 拉開股帶保護套上的扣子，並從股帶上取下來。

清涼緩衝座墊的拆卸方法

<適用在限定機種>

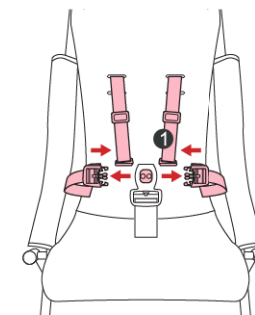
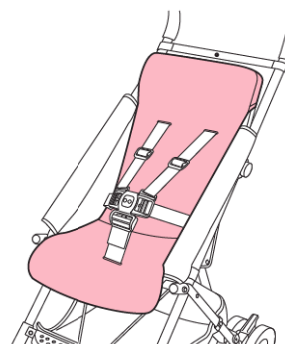

① 卸下腰帶、肩帶。

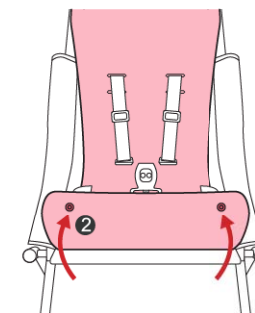

② 卸下座面裡側的扣子。

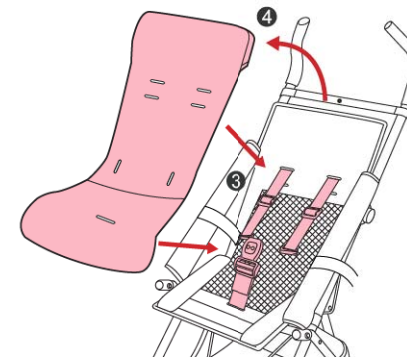

③ 拔出股帶、肩帶。
④ 取下清涼緩衝座墊。

縫製品清洗時

關於清涼緩衝座墊的洗淨方法（僅限採用機種）

・洗滌時請注意以下事項：



有關遮陽罩、肩帶、股帶、腰帶、置物籃、肩揹帶的清洗：

・請勿整件放進洗衣機內清洗，請按照下述要領清洗：

- 當有水溶性污垢時（如果汁、唾液、尿液等）可將毛巾用40°C左右的熱水浸濕，輕輕擰乾後充分擦拭污垢處，再以乾毛巾等充分吸收水分之後再置於陰涼處自然晾乾。
- 當有非水溶性污垢時（如牛奶、油脂、蛋黃等）可首先將中性洗潔劑溶解在40°C左右的熱水中，然後以刷子或海綿輕輕刷洗，再用冷水或溫水充分洗掉中性洗潔劑，再以乾毛巾吸收其中水分後置於陰涼處自然晾乾。

- 注意**
- 請勿以脫水機脫水。
 - 在屋外晾曬時，請在陰涼處，以平放方式使其自然晾乾。

日常簡易保養

關於車體及車輪的保養

◎請勿對粘附在車架上的泥土、灰塵等置之不理，請以牙刷等刷除乾淨後再用濕毛巾擦拭乾淨。

- 注意**
- 請勿在車架及車輪粘附泥土、灰塵的情況下使用。（可能是造成事故發生的原因）
 - 擦拭泥土灰塵時不要使用稀釋劑、汽油等揮發性溶劑，以免侵蝕零件。

※ 車輪屬消耗品。車輪的厚度磨掉5mm左右時請向購買之商店或本公司售後服務部門聯繫更換。（有償）

關於螺絲、螺帽類的保養

◎請經常檢查螺絲、螺帽類是否有鬆動，當發現有鬆動時，請儘速鎖緊。

- 注意**
- 萬一出現了破損、發生或發現了異常情況時，請立即停止使用，並與本公司售後服務部門聯繫。

關於添加潤滑油

- ◎潤滑油請添加一般市售之潤滑油即可。
- ◎添加潤滑油前請先清洗掉車體上的泥土與灰塵，並擦乾水分。
- ◎加油時請在單一部位添加2~3滴即可。

◎當出現不能靈活折疊或無法順利打開車體的情況時，請在下圖 ➡ 實心箭頭處添加少量的潤滑劑，並返復2~3次開閉操作。

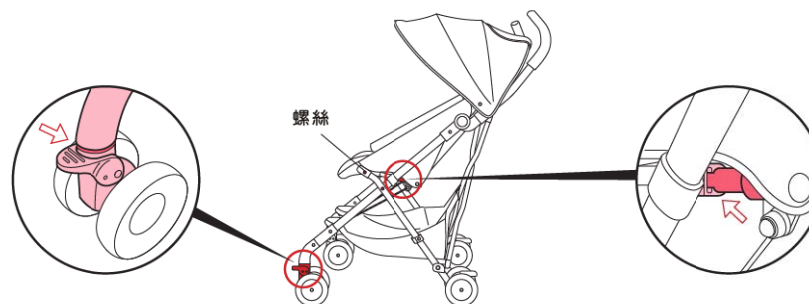

關於檢查與售後服務

- ◎請經常檢查螺絲是否鬆弛，零件是否有遺失、破損，及有無動作不良等異常情況發生。
- ◎請勿自行改造、分解，以免產生危險。
- ◎日常保養時所拆下的附件，請在仔細閱讀本說明書後正確的安裝。拆下的零件請勿隨意放棄。
- ◎本產品修理時，或在銷售配件時，同種部件可能發生缺貨，或顏色、式樣有所不同，但不妨礙使用，請予以瞭解。
- ◎使用時萬一發生故障或檢查時發現需要更換零件或修理，以及有其他異常時，請停止使用並向購入之商家或本公司售後服務部聯繫。

保管方法

- ◎短期不使用本產品時，請先清除車體與各縫製品座墊後，將本產品放入大型塑膠袋中，置於沒有日光直射的陰涼處保管。
- ◎夏季時應避免放置在高溫處保管。
- ◎請勿在本產品上面放置重物，或在施加壓力的狀態下保管，否則會產生車體變形或事故發生的原因。



cookie

User Guide in Chinese and English
/ Product warranty

Thank you for purchasing the product from our company. This product, a single-use baby stroller, is for babies aged beginning six months after birth until 36 months old who weigh less than 15 kg.



Please read this manual carefully before use for correct instruction. Keep this manual in good condition. Please accurately install the components not been assembled after carefully reading through this manual. This booklet must be well-maintained after use.

Table of Contents



Before you Begin	19
Label of the User guide	19
Notice of application	19
Warning	19
Attention	21
Prohibition	21
When the product is taken out of the package	22
Names of component	22
Product Features	22
Before babies sit in	23
To open the baby stroller	23
Usage of the Front Wheel Fixer	24
Usage of the Rear Wheel Brake	24
When babies sit in	25
Disassemble belt and shoulder strap	25
Height adjustment of shoulder strap	25
How to fasten shoulder strap when babies sit in	25
Adjustment of thigh strap	26
Adjustment of belt	27
Adjustment of shoulder strap	28
How to operate	28
Usage of the Sun Shade	28
Usage of the Bottom Basket	28
Usage of the Carrying Strap	29
Fold the baby stroller	29
Sewn parts maintenance	31
To remove the Sun Shade	31
<Installation>	31
To remove the Bottom Basket	31
<Installation>	31
To remove the Thigh strap protective cover	32
How to disassemble the cool cushion seat	32
Sewn parts maintenance and cleaning	33
Daily easy maintenance	33
Check-up and customer service	34
Storage	34

Before you Begin

Application	This product is a single-use baby stroller for babies outdoors.
Age of babies	Six-month old from birth to 36-month old.
Weight limitations	Less than 15 kg.
For continuous use	Within one hour of sitting position.

Label of the User guide

※ Symbols of "Warning", "Caution", "Prohibition" are labeled according to the hazardous degree and severity of danger and damage that may be caused when users do not follow the notice of application properly. The contents are extremely important and users are advised to pay attention.

Label	Labels' Meaning
 Warning	Improper handling might cause death or serious injuries to the users.
 Caution	Improper handling might cause injuries to the users or damage to the product.
 Prohibition	Please do not attempt the prohibited actions that are mentioned in this manual by all means.

Notice of Application

To avoid accidents, please read carefully before use for correct instructions to use the baby stroller.

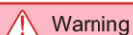

Warning Improper handling might cause death or serious injuries to the users.

• Concerns for the accidental fall of babies to cause injury.

• In fear of the tipping of the stroller and the child may fall out and get hurt.



• Do not remove the Safety Waist Belt and Safety Thigh Belt for other usage.



• Do not allow two children to sit on or outside the seat pad of the stroller at a time.



• When waist safety seatbelt is loose, it is possible babies will fall accidentally when standing. Please adjust waist seat belt based upon babies' growth.



• Do not use the stroller when going up and down the stairs, the escalator, or somewhere with a distance gap.



Warning Improper handling might cause death or serious injuries to the users.

• Concerns for the accidental fall of babies to cause injury.

• In fear of the tipping of the stroller and the child may fall out and get hurt.



• Do not let child stand on the stroller.



• When the baby is riding in the stroller, other than the Bottom Basket, do not hang other objects on the Handle Bar, or hang something too heavy on the stroller.

• In fear of the sliding and tipping of the stroller on a slope and the child may get hurt.

• Concerns for accidental fall of babies or inappropriate use of baby stroller to cause babies jammed.



• When the baby is riding in the stroller or something is put inside the stroller, do not overtrust the Rear Wheel Fixer, the structure of which is not the same as car's safety brake system.



• When the baby is riding in the stroller, do not hold the stroller in the air directly.



• When the baby is riding in or being held away from the stroller make sure the Rear Wheel Fixer is on and the stroller does not move.



• When using the stroller, make sure the locks on the left and the right are fully positioned.



• When the baby is riding in the stroller, do not leave and let the stroller unattended.



• When use the baby stroller during daytime in summer, the temperature in the stroller will get very high due to the temperature on the road surface. Avoid use it for a long period of time.

Caution Improper handling might cause injuries to the users or damage to the product.

- When operate every part of the stroller, please caution in every details.
- Please be especially careful every movable joint position when folding or opening the body of baby stroller to avoid jamming the babies or users. Avoid excessive movement to cause the stroller hit the babies or users.

Mistakes or careless use will cause regretful accidents or personal body injuries. Please be very careful.



• When you operate to fold the baby stroller, please do not let babies or toddlers get close.



• When you push the baby stroller, please do not use excessive strength to avoid fingers been jammed or body of stroller hit on self.

- Beware of any loose of screws or screw caps when using the product.
- Do not walk the stroller by raising the front wheels. This action may cause the back frame to warp or break.
- Do not allow little child to operate the stroller.
- When you operate to fold the baby stroller, please do not let babies or toddlers get close.
- **When the baby is riding in the stroller, for safety, walk in a normal speed (about 4 kilometers per hour).**
- Do not allow little child over 15 kg to ride in the stroller.
- Even empty, the stroller should not be put in hazardous areas such as on a slope or sidewalk close to the driveway.
- The Safety Thigh Belt is strictly prohibited to wind up on the Safety Protection Lever for other usage. This action will cause the Safety Thigh Belt to break.
- Do not walk the stroller on sandy or muddy ground. Connecting and joint parts may cause problems when opening or folding the stroller if sands are inside.
- Do not place the stroller close to fire or inside a car on a hot summer day. The resin may warp and cannot maintain its original function.
- Do not let sand or dirt stuck on the frame undealt. Joint parts may cause problems when opening or folding the stroller if sands are inside.
- Please do not attach two strollers together.
- Please pay more attention because there is possibility that babies with seat belt on may stand up.
- Due to road condition, structure, functions and durability, the brake of baby stroller may not be trusted completely. In mechanical structure, brake on baby stroller is not as safe as the parking brake.
- Be very careful when passing railway light signals; do not let the wheels jammed in the railway tracks.
- Do not operate in a way that might cause malfunction of baby stroller.

Prohibition Please do not attempt the prohibited actions that are mentioned in this manual by all means.

- The baby stroller is dismantled, assembled or modified by people other than Aprica's Service Personnel.
- The baby stroller is used when screws or screw caps are loose.
- It is prohibited that the protector sits on armrest on the side or on the front.
- The baby stroller is used to transport goods.
- Objects are hung on the Handle Bar or the Safety Protection Lever for transportation purpose.
- The baby stroller is used after being struck heavily or falling down.
- The baby stroller is used as toy for little child.
- It is prohibited that the baby stroller is used for any other purpose besides transportation of babies.

When the product is taken out of the package

- After the product is taken out of the package, please make sure every component is included without missing or damages.
- In the case of missing component or damages, please contact the store this product is purchased or our company.

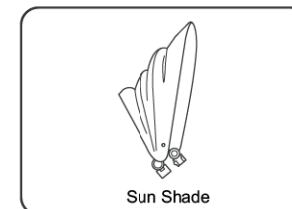

Sun Shade

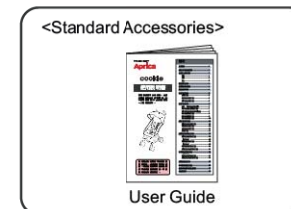

<Standard Accessories>

User Guide

- Please refer to P23 when opening the baby stroller.
- Please refer to P31 when opening the sunshade.

Names of components

<Product Features>

- The material of baby stroller is light-weight aluminum.
- After folding the stroller, it is in a self-standing position.
- Front-back left-right folding of baby stroller.
- Fasten the back side of handle bar.
- Front wheels are direction wheels.

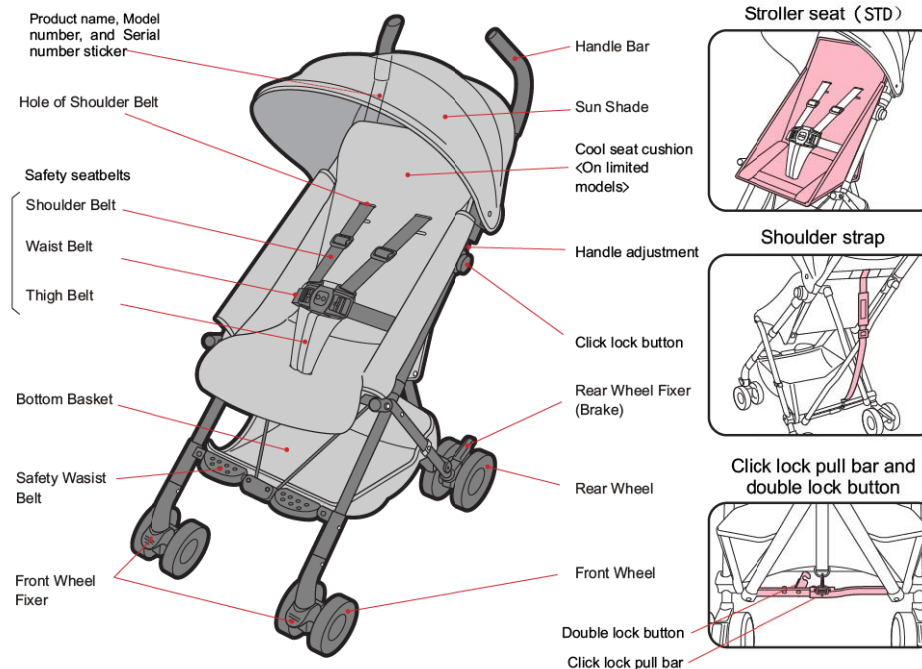

Before babies sit in

To open the baby stroller

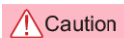

- Please use with caution to avoid users' hand or fingers jammed in moveable components.
When misuse, it is possible to cause accidents or serious injury to users.
- Make sure babies are not around the area the product is operated.

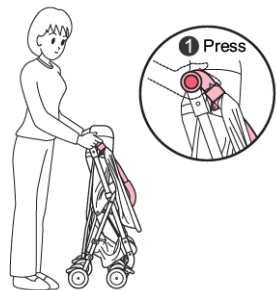

- Press click lock buttons on either side with both hands.

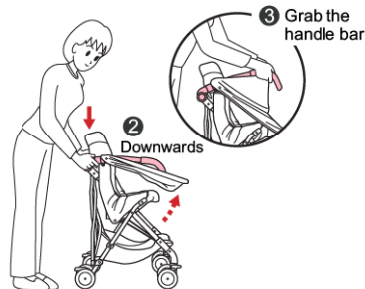

- Press the click lock buttons and the handle bar adjustment area.
- Grab the handle bar with both hands.

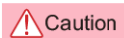

- Open the baby stroller when the button is pressed (please use caution to avoid hands and fingers jammed); open the stroller with both hands grabbing the handle bar.

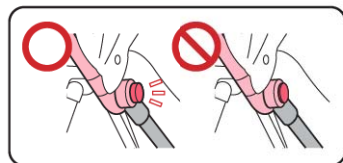

- Open the Handle Bar.

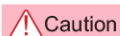

- Please open the handle bar again to make sure it is locked in the case that click lock is not completely secured.

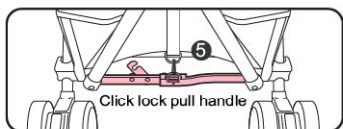

- Expand it with click lock pull handle pressed down.

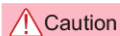

- Please make sure that the click lock pull handle is actually expanded.

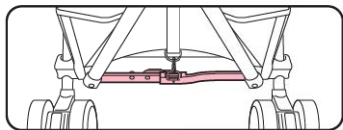

- Button on the double lock button

Usage of the Front Wheel Fixer

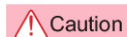

- When walking on uneven surface, slope or tilt area please fasten the front wheel fixer on either side and do not fasten the direction wheels; it is possible to cause injury of babies once the baby stroller is tilt.

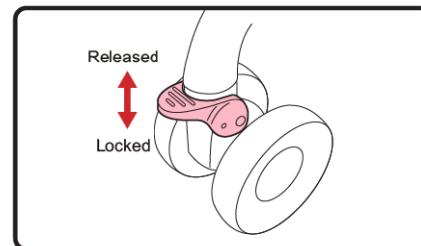
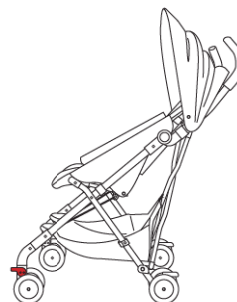

<Released>

- When walking on a smooth road condition.

<Locked>

- When walking on an uneven, slope or tilt road surface.
- When folding the baby stroller.

Usage of the Rear Wheel Brake



- Please do not trust the brake system completely when babies sit in. The brake system on baby stroller is not as safe as the parking brake in cars.

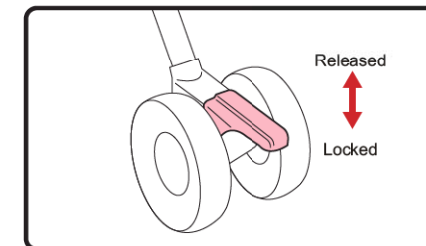
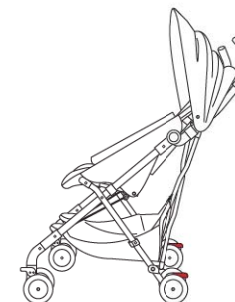

- Lock on either side of brakes of back wheels when leaving baby stroller behind without babies in it.

- Please do not leave the baby stroller behind when babies sit in.

- Slowly move the baby stroller up front and backwards to make sure whether the brake is actually secured.

When babies sit in

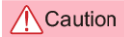

- Please use with caution to avoid users' hands or fingers jammed in moveable components.
When misuse, it is possible to cause accidents or serious injury of users.
- Make sure whether the brakes on either side are secured before babies sit in.

1. How to disassemble waist belt and shoulder strap

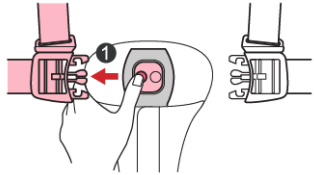

- Press the click button on either side of thigh strap to take off waist belt.

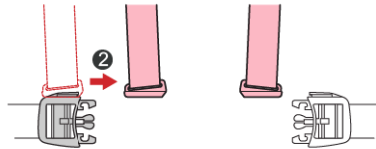

- Take off shoulder strap from the click button of waist belt.

2. How to adjust the height of shoulder strap

- Two-step adjustment of the height of shoulder strap.

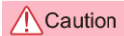

- Adjust the height of shoulder strap based upon babies' growth.

Based upon babies' age in months (physical condition)	Position of shoulder strap guiding hole
6 months ~ 30 months	Lower section
24 months ~ 36 months	Upper section

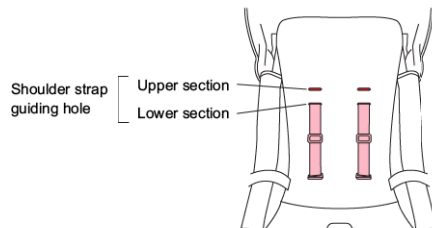

<How to adjust>

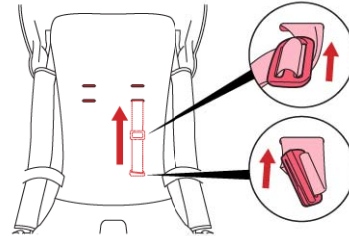

- Pull out the shoulder strap from the back side of stroller backrest.

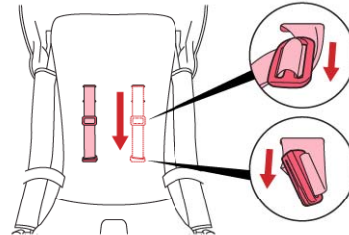

- Wear the shoulder strap from shoulder strap guiding hole following the body of babies.

3. How to fasten shoulder strap when babies sit in

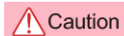

- Shoulder strap needs to be installed carefully; it must be installed on waist belt. It is possible that shoulder strap may strangle babies and cause injuries.

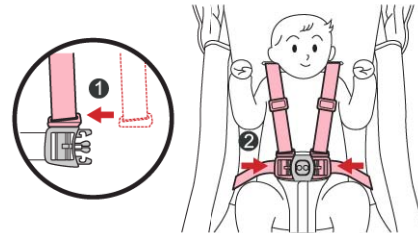

- Insert shoulder strap on waist belt.
- Insert waist belt on thigh strap.

4. How to adjust thigh strap

<When it is pulled out>

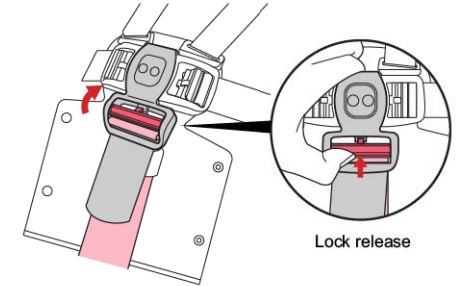

- Release the lock.

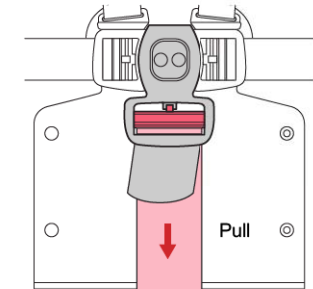

- Pull the thigh strap downwards when the lock is released.

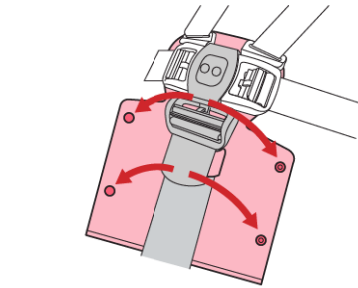

- Open the button of thigh strap protective cover and take off the thigh strap protective cover.

<When it is shortened>

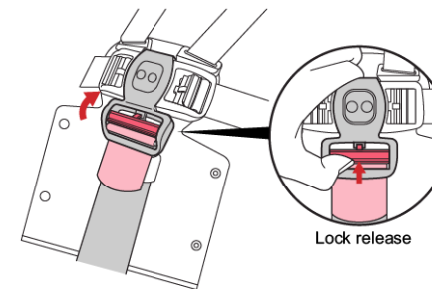

- Release the lock.

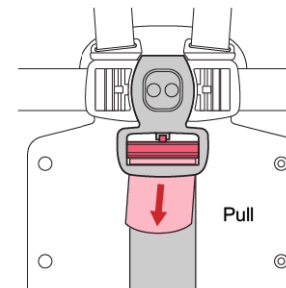

- Pull the thigh strap.

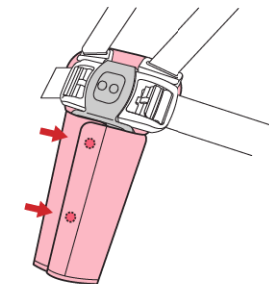

- Button on the thigh strap protective cover.

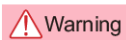

- It is possible that babies may fall when they are standing with waist seatbelt loosened. Please adjust waist seatbelt according to babies' growth.

5. How to adjust waist belt

<When it is shortened>

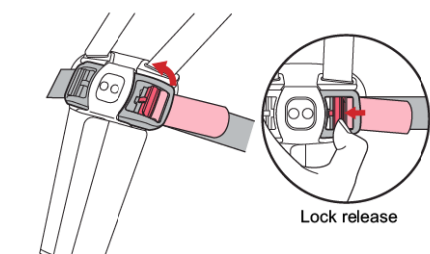

- Release the lock.

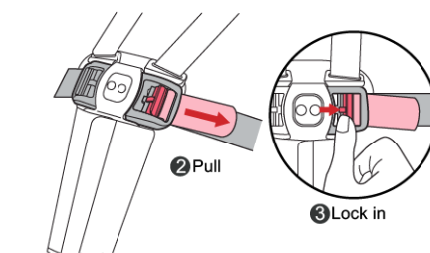

- Pull the waist belt.
- Lock in.

<When it is pulled out>

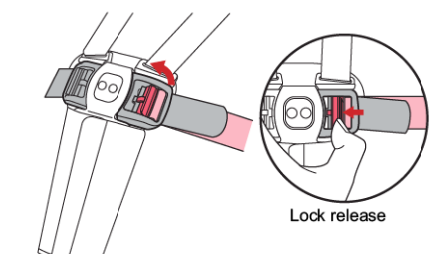

- Release the lock.

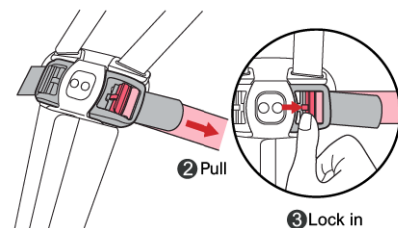

- Pull the waist belt.
- Lock in.

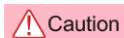
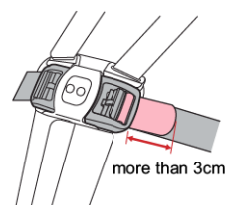

- The remaining portion of the end of waist seatbelt (as pointed by arrow) must be more than 3cm in length.

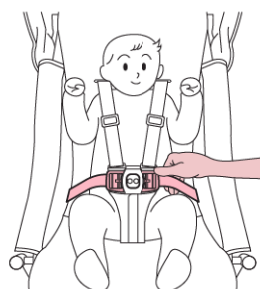

- Adjust the length of waist belt (the length of waist belt is adjusted to approximately four adults' fingers around babies with belt on).

6. How to adjust shoulder strap

<When it is shortened>

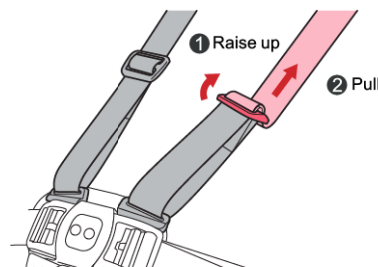

<When it is pulled out>

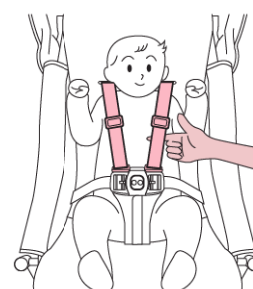
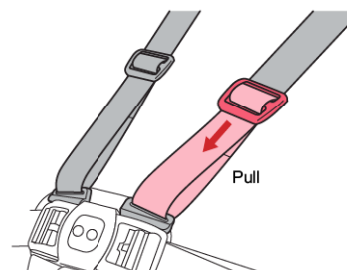

- Adjust the length of shoulder strap (the length of shoulder strap is based on approximately one adult's finger around babies with belt on).

How to operate

Usage of the Sun Shade

<When open the sunshade>

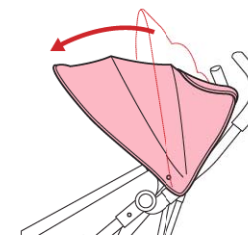

<When open the sky window>

<On limited models>



Usage of the Bottom Basket

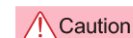

- Please do not put in sharp materials; it is possible to cause injury if sharp materials get through sewn stitches.
- Please do not put objects more than 2.5 kg inside of the basket.



Usage of the Carrying Strap

- After folding the baby stroller, shoulder strap may be used to carry baby stroller on the shoulder when walking.
- Please adjust the length of back strap according to users' needs.

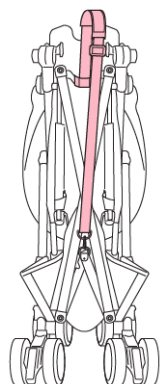

Caution

- Please wipe clean the grease, soil, and sand on baby stroller to avoid dirt on users.



- Please adjust the length of shoulder strap when it is open.

Fold the baby stroller

Caution

- Please use with caution to avoid users' hands or fingers jammed in moveable components.
When misuse, it is possible to cause accidents or serious injuries of users.
- Make sure babies are not near when the product is in operation.

<Before close it>

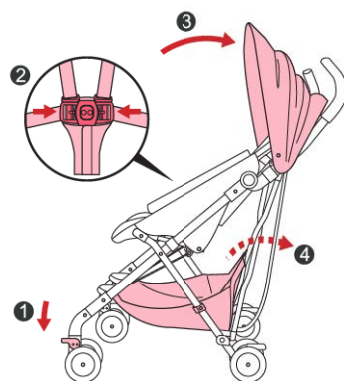

- Fasten front wheels on either side.
- Secure shoulder strap and waist belt on thigh strap.
- Close up the sunshade.
- Take out the objects in the storage basket on the bottom.

Fold the baby stroller

Caution

- Please use with caution to avoid users' hands or fingers jammed in moveable components.
When misuse, it is possible to cause accidents or serious injuries of users.
- Make sure babies are not near when the product is in operation.

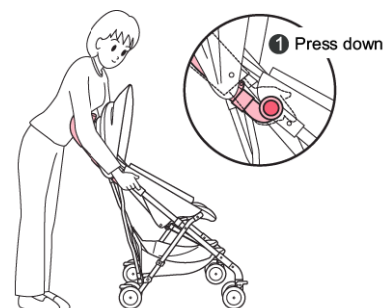

- Press the click button on either side with both hands.

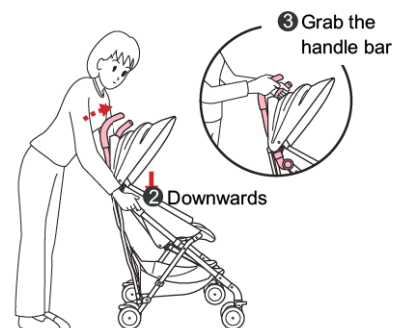

- Press the click lock button and the handle bar adjustment area.
- Grab the handle bar with both hands.

Caution

- Please close up and fold the product when the button is pressed to avoid hands (or fingers) jammed; then, close it with both hands grabbing the handle bar.

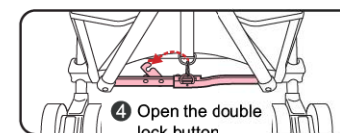

- Open the double lock button.

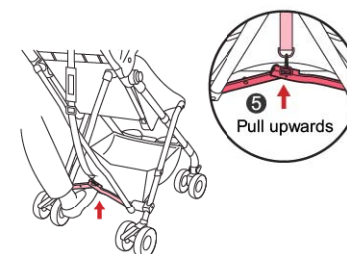

- Pull up the central portion of lock connecting bar. Pull the back strap; then, the lock connecting bar may be pulled up.

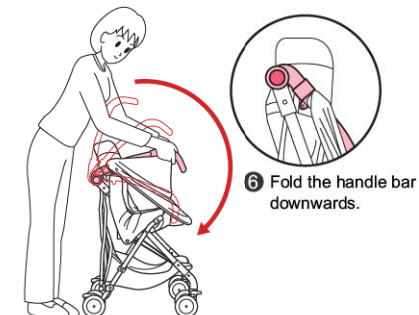

- Close up the handle bar.

Caution

- Please fold the handle bar again to make sure it is locked if the click lock is not completely secured.

Sewn parts maintenance

To remove the Sun Shade

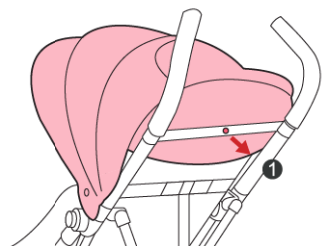

- 1 Remove the button on the back.

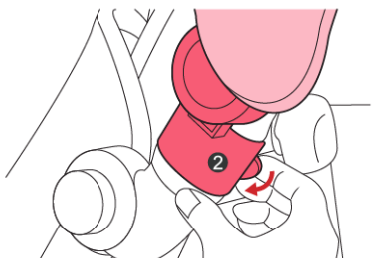

- 2 Pull the sunshade bottom stand and take off.

<Installation>

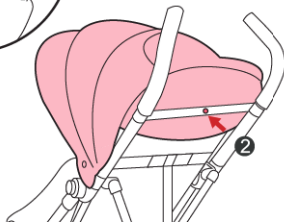
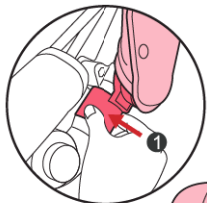

- 1 Put the sunshade in the innermost position.
- 2 Fasten the button on the back.

To remove the Bottom Basket

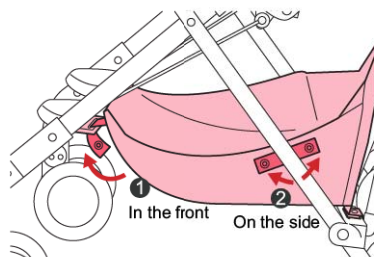

- Remove buttons 1 in the front and 2 on the side.

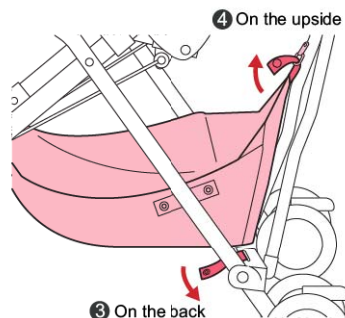

- Remove the buttons 3 on the back (of either side), and 4 on the upside.

<Installation>

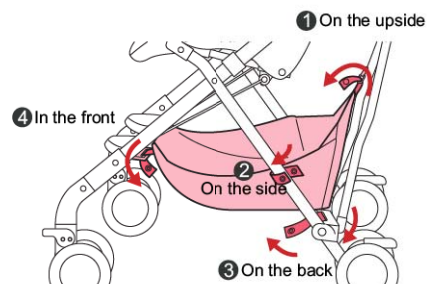

- 1 Pull the basket strap on the upside through hanger and button up.
- 2 Roll up the side basket strap on stroller tubes and button up (on either side).
- Pull the basket strap 3 on the back and 4 in the front through holes and button up (on either side).

To remove the Thigh strap protective cover

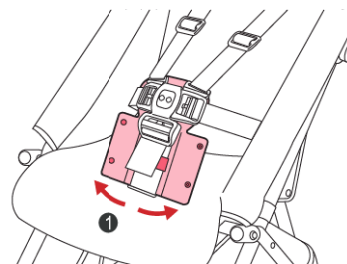

- 1 Remove the button.

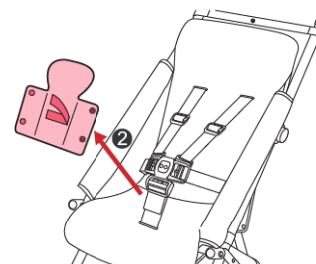

- 2 Open the button on thigh strap protective cover and take it off from thigh strap.

How to disassemble the cool seat cushion

<For limited models>

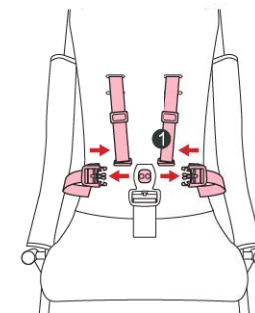
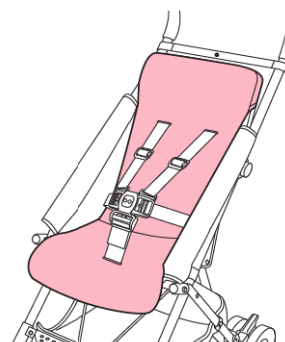

- 1 Disassemble waist belt and shoulder strap.

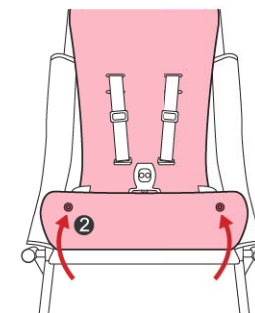

- 2 Remove the button at the inside of stroller seat.

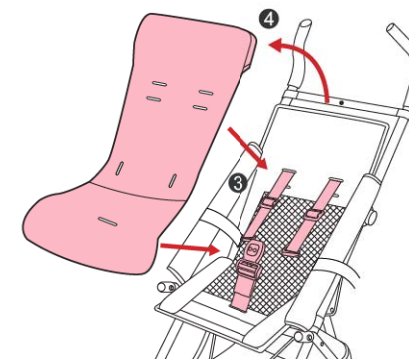

- 3 Pull out thigh strap and shoulder strap.
- 4 Take off the cool seat cushion.

Sewn parts cleaning

Cleaning instruction of the cool seat cushion (For limited models)

· When washing, please pay attention to items as follows:



Cleaning sunshade, shoulder strap, thigh strap, waist belt, bottom basket, and shoulder scarf:

· Please follow the cleaning instruction as below instead of putting the entire product in washing machine for cleaning:

- Use a hot wet towel in approximately 40 degrees to clean water-resoluble dirt (such as juice, saliva, and urine); slowly twist to dry the towel and wipe clean the soiled area. Use a dry towel to absorb water, and then put in a cool place to dry.
- Use hot water in approximately 40 degrees with a neutral detergent in it to clean non water-resoluble dirt (such as milk, grease and egg yoke). Use cold or lukewarm water to wash away the detergent, dry it with a clean towel in a cool place.

- Caution**
- Please do not use dryer to dry any component.
 - Please lay flat to sun dry in a cool place outdoors.

Daily easy maintenance

Maintenance of stroller body and wheels

◎ Please do not ignore dirt or dust attached on stroller bars. Please wipe clean using a wet towel after brush the soiled area with toothbrush.

- Caution**
- Please do not use the product when the stroller bars and wheels are dirty with soil and dust (may thus cause accidents).
 - Do not use volatile solvent such as thinner or gasoline to wipe away soil or dust to avoid deterioration of components.

※ Stroller wheels are supplies. Please contact the store where this product is purchased or customer service department of our company for exchange when the thickness of wheels is off 5 mm (with compensation).

Maintenance of screws and screw head

◎ Please examine screws and screw head often to see whether they are loose; please screw them tight when the situation occurs.

- Caution**
- In the case that there is damage or abnormal condition, please stop use the product immediately and contact customer service department of our company.

Add lubricant

- ◎ Please add regular lubricant in the market.
- ◎ Please wash and clean the dirt and dust on the stroller and dry it before adding lubricant.
- ◎ Please only add 2~3 drops of lubricant on a single component of the stroller.

◎ In the case that the stroller cannot be easily folded or opened, please add a small amount of lubricant as shown in illustration below pointed by a solid arrow ⇒ and repeat the open-close operation 2~3 times.

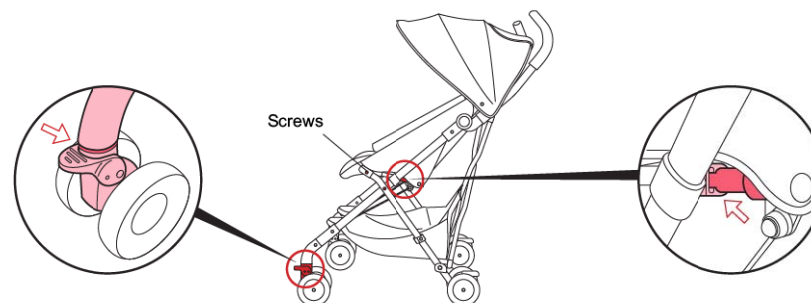

About Check-up and Customer Service

- ◎ Please examine often whether the screws are loose, components are lost, damaged or any abnormality in operation of the stroller happened.
- ◎ Please do not modify or disassemble the product to avoid accidents.
- ◎ Please install the attachments removed when administering daily maintenance after reading this manual carefully. Do not throw away any components disassembled.
- ◎ Please take into consideration that it is possible to have parts in color or style that are unavailable when this product is in repair or sales for accessories.
- ◎ In the case of malfunction, examination, exchange or repair is needed, or the other abnormality, please stop use the product and contact immediately the store where this product is purchased or customer service of our company.

Storage

- ◎ When this product is not in use for a short period of time, please clean up the stroller body and every sewn parts of stroller seat. Put this product in a big sized plastic bag in a cool spot without direct sunlight for storage.
- ◎ Please avoid storing the product in a hot place in summer.
- ◎ Please do not place heavy objects on this product or apply pressure on it when in storage; it will cause changes of stroller body or possible accidents.